

PROMENADE, LOGAN, UTAH  
**LAND USE LEGEND**

- COMMERCIAL / OFFICE / OPEN SPACE:  
Aviation-compatible Development Zone
- COMMON OPEN SPACES
- CONCEPTUAL OPEN SPACES
- LUXURY APARTMENTS
- ACTIVE ADULT CONDOMINIUMS
- CONDOMINIUMS
- TOWNHOMES
- MANSION HOMES
- RETIREMENT MANSION HOMES
- RETIREMENT HOMES: SFD LOTS
- SINGLE FAMILY: 5,500 TO 6,500 S.F. LOTS
- SINGLE FAMILY: 7,000 S.F. LOTS

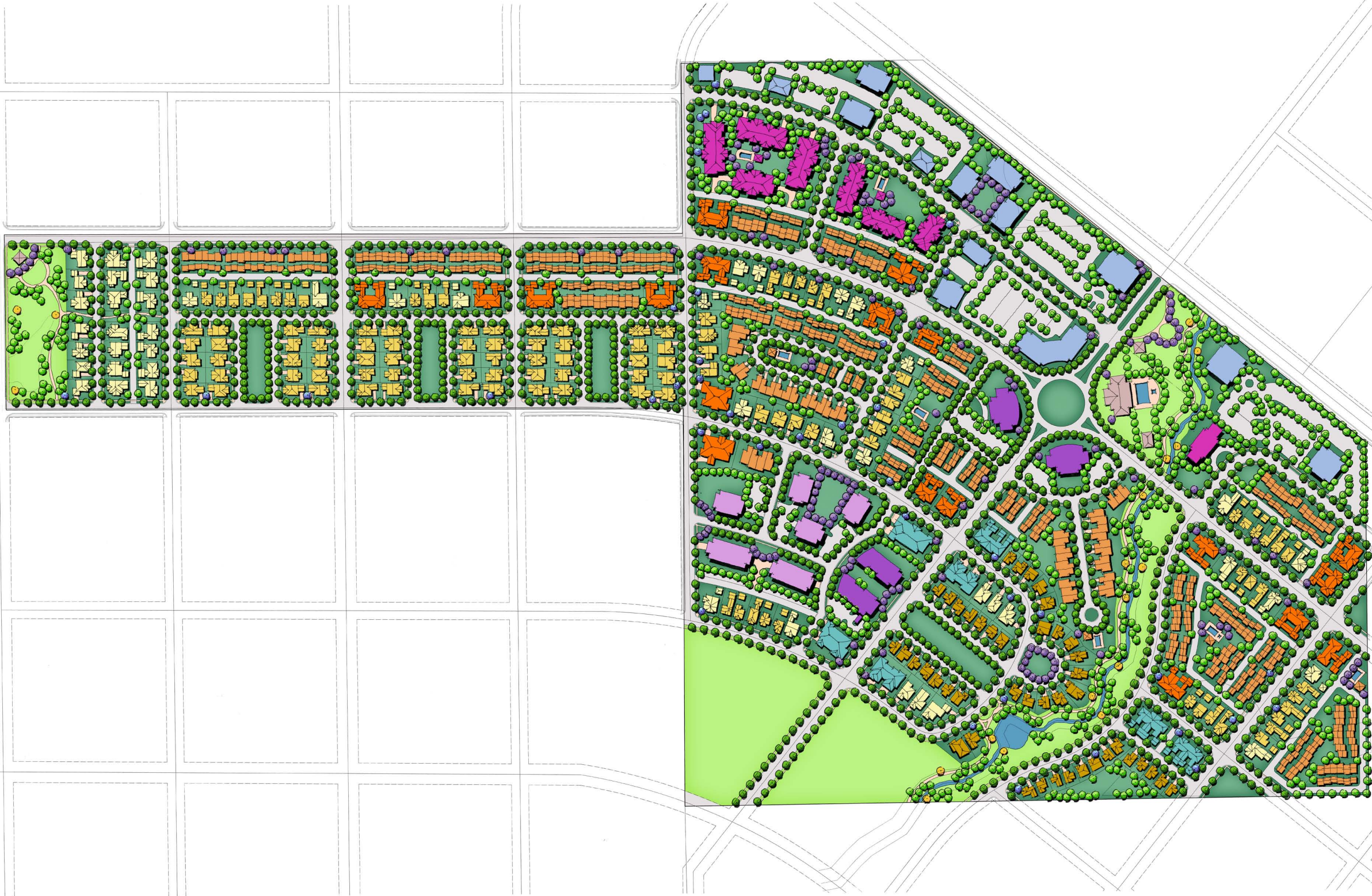

Illustrative Concept Plan  
**PROMENADE**  
 A NEW RESIDENTIAL COMMUNITY  
 2800 NORTH AIRPORT ROAD  
 LOGAN, UTAH

LOGAN LAND SOLUTIONS, LLC  
 435 EAST 125 NORTH  
 PROVIDENCE, UTAH

**R. MICHAEL KELLY**  
 ARCHITECT  
 LAND PLANNING • LANDSCAPE ARCHITECTURE  
 P.O. Box 605, MDR-06, UT 84302 435.733.2055